

## Quick Start Guide for Weatherproof Outdoor Housing CCDA1425-WPH

**Model Number**      **Part Code**      **Designation**  
 CCDA1425-WPH      2GF1192-8BA      Weatherproof Outdoor Housing

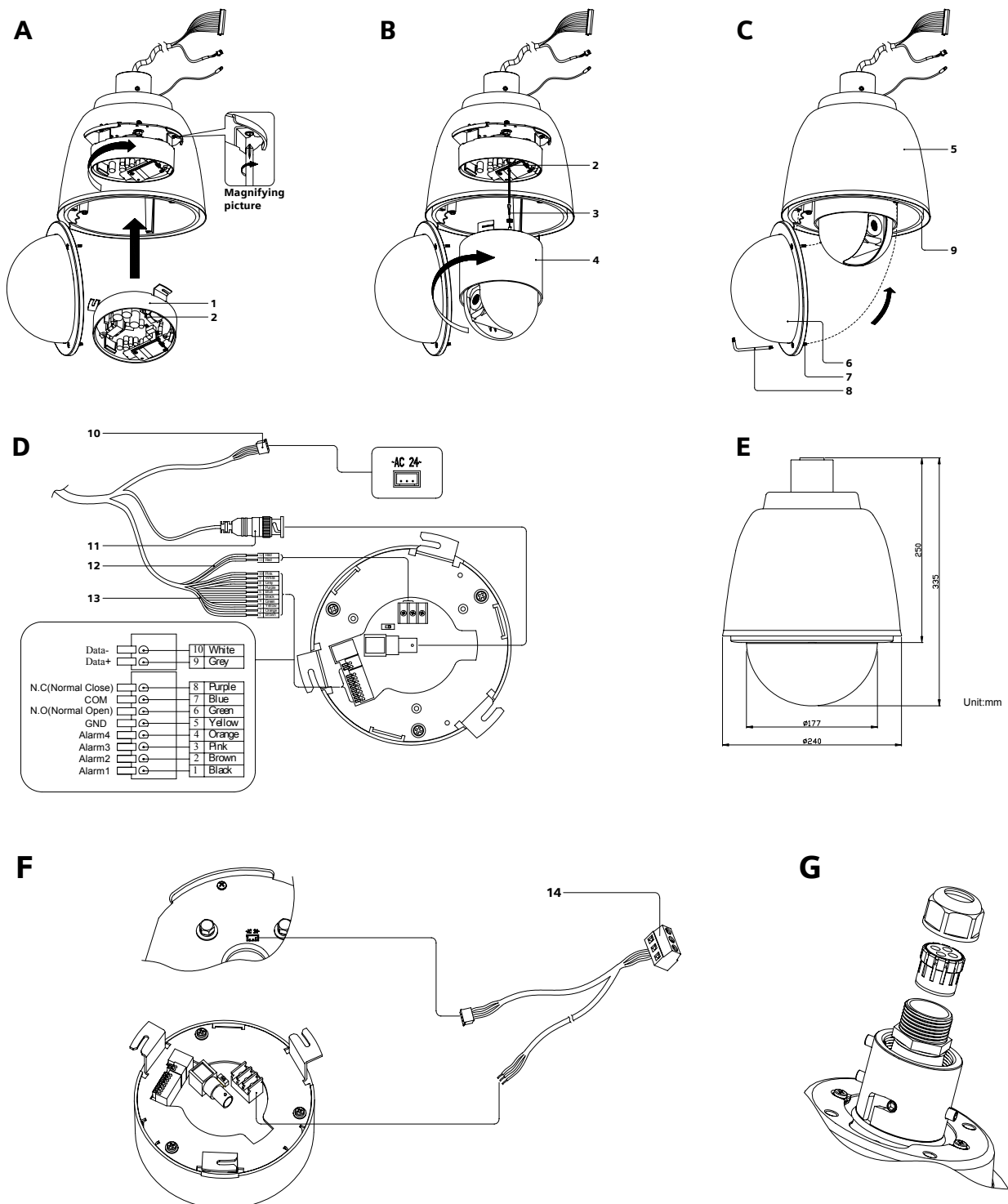

## English

### Important

This quick start guide is only intended for use by installers who have an adequate working knowledge of video systems! This guide outlines the most important information about the outdoor housing. It is, however, vital that you also refer to the detailed CCDA1425 instruction manual.

### Package content

- Outdoor housing
- Safety screwdriver
- Gland with two-entry rubber
- Additional one-entry & four-entry rubbers
- Y cable
- Sealed pins

### Outdoor housing parts

See figures A, B, C and D.

1. Dome base
2. Hook
3. Support wire
4. Dome drive
5. Sun shield
6. Dome cover
7. Safety screws
8. Safety screwdriver
9. Unit housing
10. Power cable
11. Video cable
12. Power-in cables
13. Communication cables

### Installing Dome in housing

#### A) Without PG-gland

##### Wallmount incl. junction box

1. Attach the video cable (11) (included with the dome housing) to the video connector on the dome base (1).

2. Connect the communication cables (13) directly to the appropriate terminals (indicated by colour) on the dome base (see figure D).
3. Connect the power in cables (12) directly to the termination of power on the dome base (see figure D).
4. Tighten the fixing screw to fix the speed dome base into the housing (see figure A magnifying picture).
5. Connect the support wire (3) to the hook (2) of the dome base (see figure A).
6. To lock the dome drive (4) to the dome base, line up the notch with the label and turn to the right with both hands (see figure B).
7. Hold the dome cover (6) to maintain the matched position. Tighten the 3 screws (7) with a screwdriver (8) and lock the dome cover to the unit housing (9) (see figure C).
8. The installation is completed.

#### B) With PG-gland

##### Simple wall and pendant mount

1. Separate the sealing nut & two-entry rubber from the outdoor housing (figure G), and then take out the speed dome cables (see figure D: 10, 11, 12, 13) from the outdoor housing
2. Connect the Y Cable (the ends with contact shoes) to the Power Terminal, and the other end is for the Heater Connector (see figure F)
3. Replace the two-entry rubber with four-entry / one-entry rubber based on the wiring (see figure G)

#### INFO:

We recommend the usage of PG-Gland for all kind of mounts to ensure improved IP66 of housing.

Connect lines from field with the Power Terminal, BNC connector, Alarm IN/Out & Data at the dome, pulling the cable through the one / four-entry rubber.

4. Screw the sealing nut.
5. Make sure, gland is fixed properly to keep humidity outside housing and ensure IP66.

### Operation and storage

Do not operate or store the unit:

- At extremely hot or cold places.
- Close to sources of strong magnetism.
- Close to sources of powerful electromagnetic radiation such as radios or TV transmitters.
- Where exposed to mechanical vibrations.
- Close to fluorescent lamps or objects reflecting light.
- Under unstable or flickering light sources.

### Specifications

Height:	350 mm
Diameter Ø:	240 mm
Operating temperature:	-30 – +50 °C
Storage temperature:	-40 – +60 °C
Weight:	4.0 kg (max)
Relative humidity:	0 – 90%
Bubble:	clear
Heater switch temp:	On: +4°C / Off: +16°C
Heater.:	24 VA
Input Voltage:	24 V AC
Power consumption:	26 VA housing only
Protection type:	IP66



#### CAUTION

1. Ensure that the safety wire (located in the dome base) is engaged.
2. Align notch with "OPEN" arrow and turn dome until notch meets arrow in "LOCKED" position.
3. When using outdoor housing ensure, that safety-wire of dome housing is always fixed firmly to the mount, to prevent unit from falling down.
4. Check assembly by pulling. Assembly should not come apart.

English		For more detailed information please refer to the Instruction Manual for ¼" Speed Dome Cameras.
Deutsch		Nähere Informationen hierzu finden Sie im Installationshandbuch für ¼" Speed Dome Cameras.
Français		Veillez consultez le guide d'opération des caméras ¼" Speed Dome pour d'information plus détaillée.
Nederlands		Uitgebreide Informatie find u in het instructie handboek voor ¼ Speed Dome Kameras.
Italiano		Per maggiori dettagli si rimanda al manuale specifico di istruzione della telecamera Speed Dome ¼".
Polski		Więcej informacji zawiera instrukcja obsługi zintegrowanej kamery szybkoobrotowej ¼".
Svenska		För ytterligare information hänvisas till installationsmanualen för ¼" Speed Dome Cameras.
Español		Por favor, para una información más detallada, consulte con el manual de instrucciones de los domos de alta velocidad de ¼".
Česky		Pro podrobnější informace se prosím podívejte do návodu pro obsluhu ¼" Speed Dome kamery.